

the intersection of Sherman Hill Road and Route 22 was the school, now identified as School No. 4, and the dwellings of O. Tabor, J. Preston, and H. W. Preston.

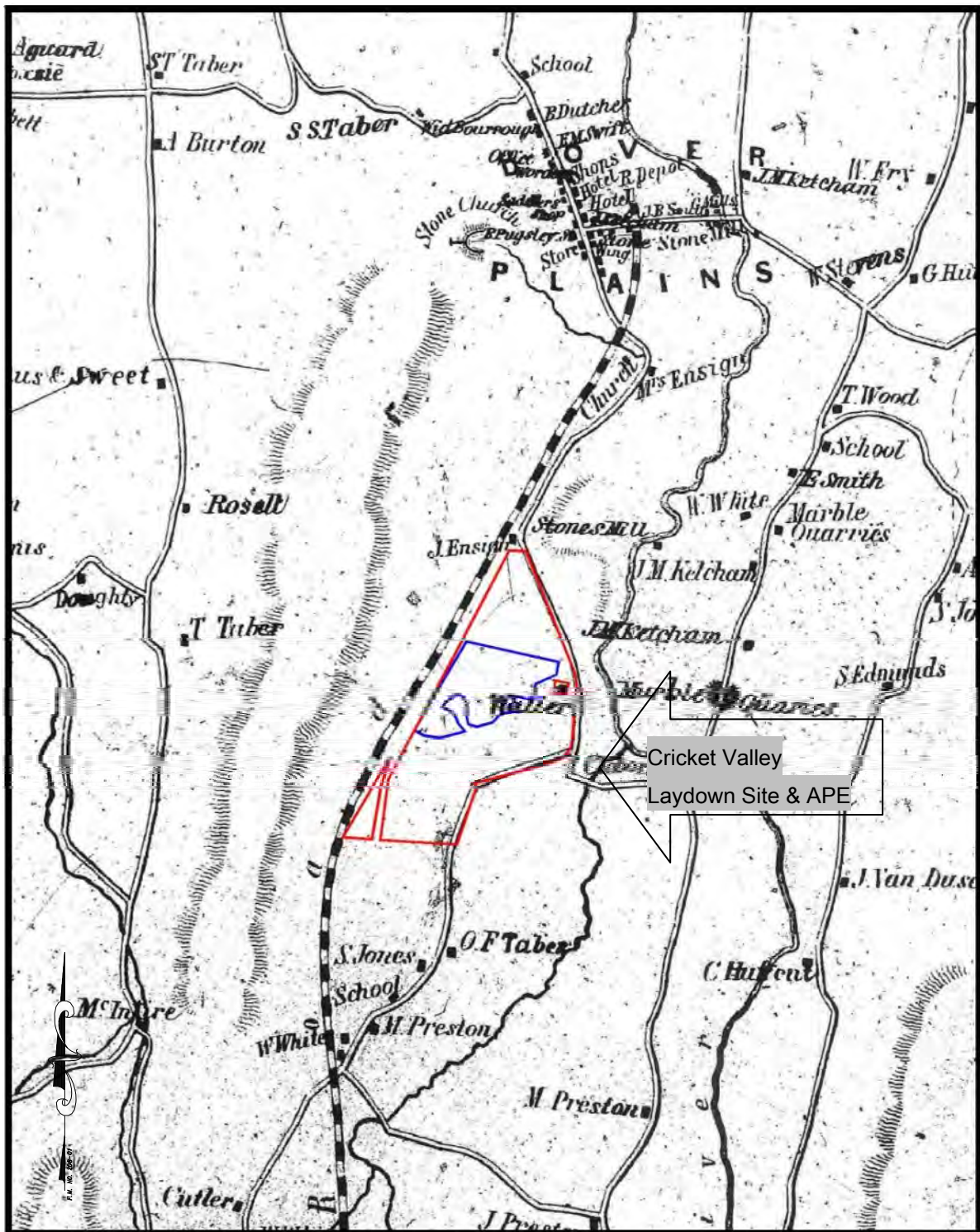

**Map 3:** J. C. Sidney's 1850 Map of Dutchess County, New York. Red line indicates property boundary. Blue line indicates APE. Scale: 1"=1800'.

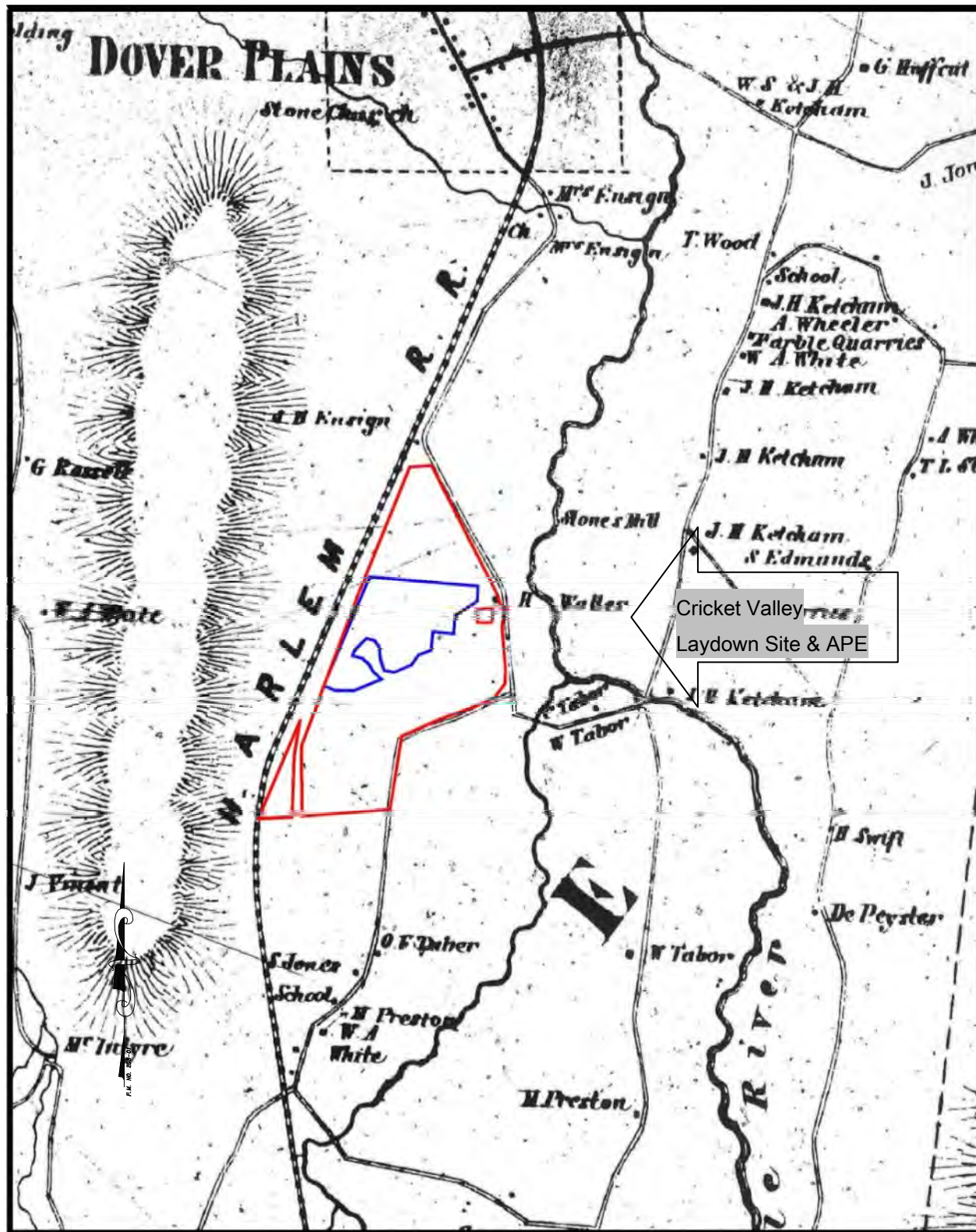

**Map 4:** Corey & Bachman's 1858 Map of Town of Dover in John E. Gillette's *Map of Dutchess County, New York*. Red line indicates property boundary. Blue line indicates APE. Scale: 1"=1500'.

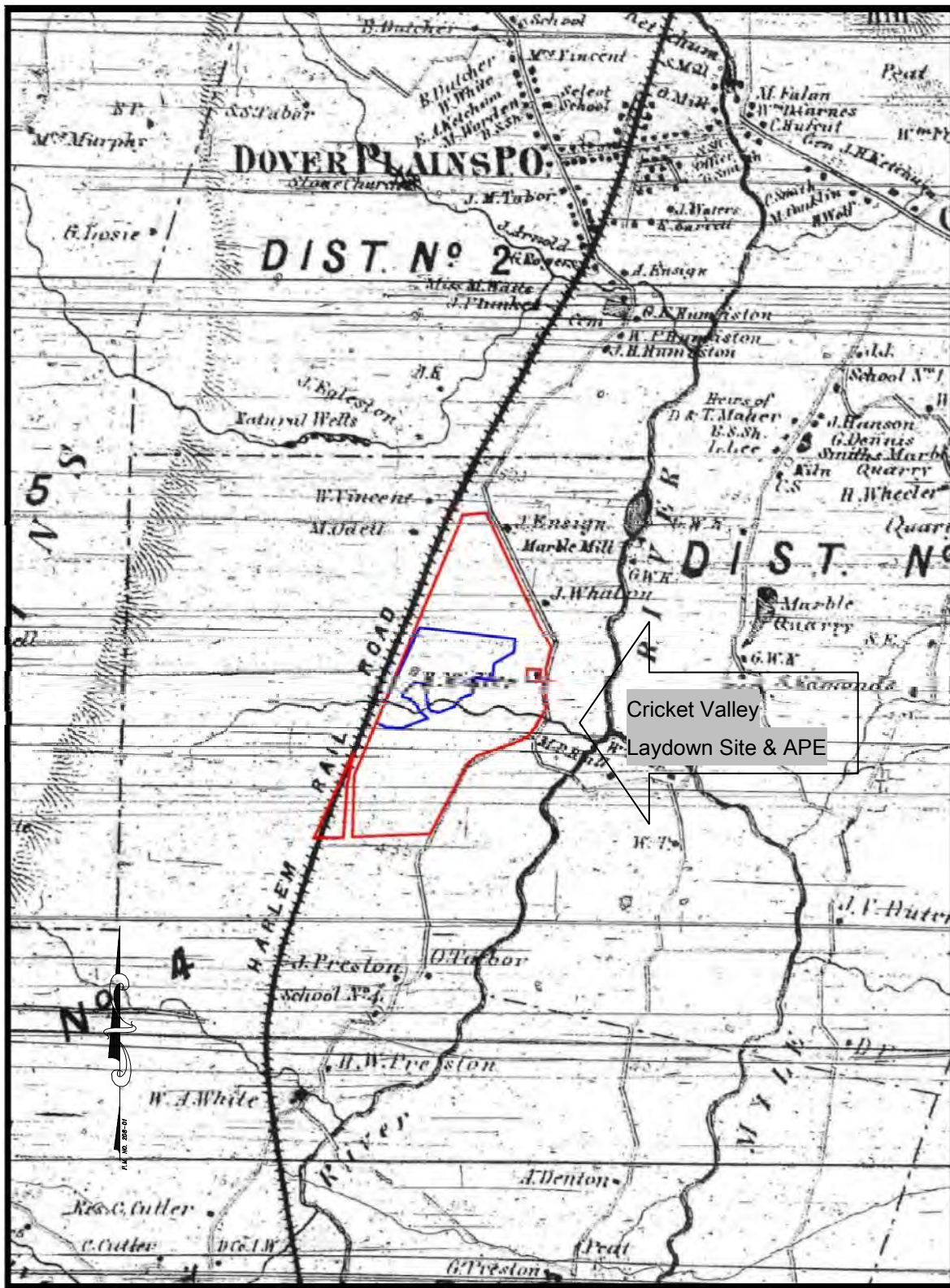

**Map 5:** 1867 Map of the Town of Dover in F. W. Beers' *Atlas of New York and Vicinity*. Red line indicates property boundary. Blue line indicates APE. Scale: 1"=1800'.

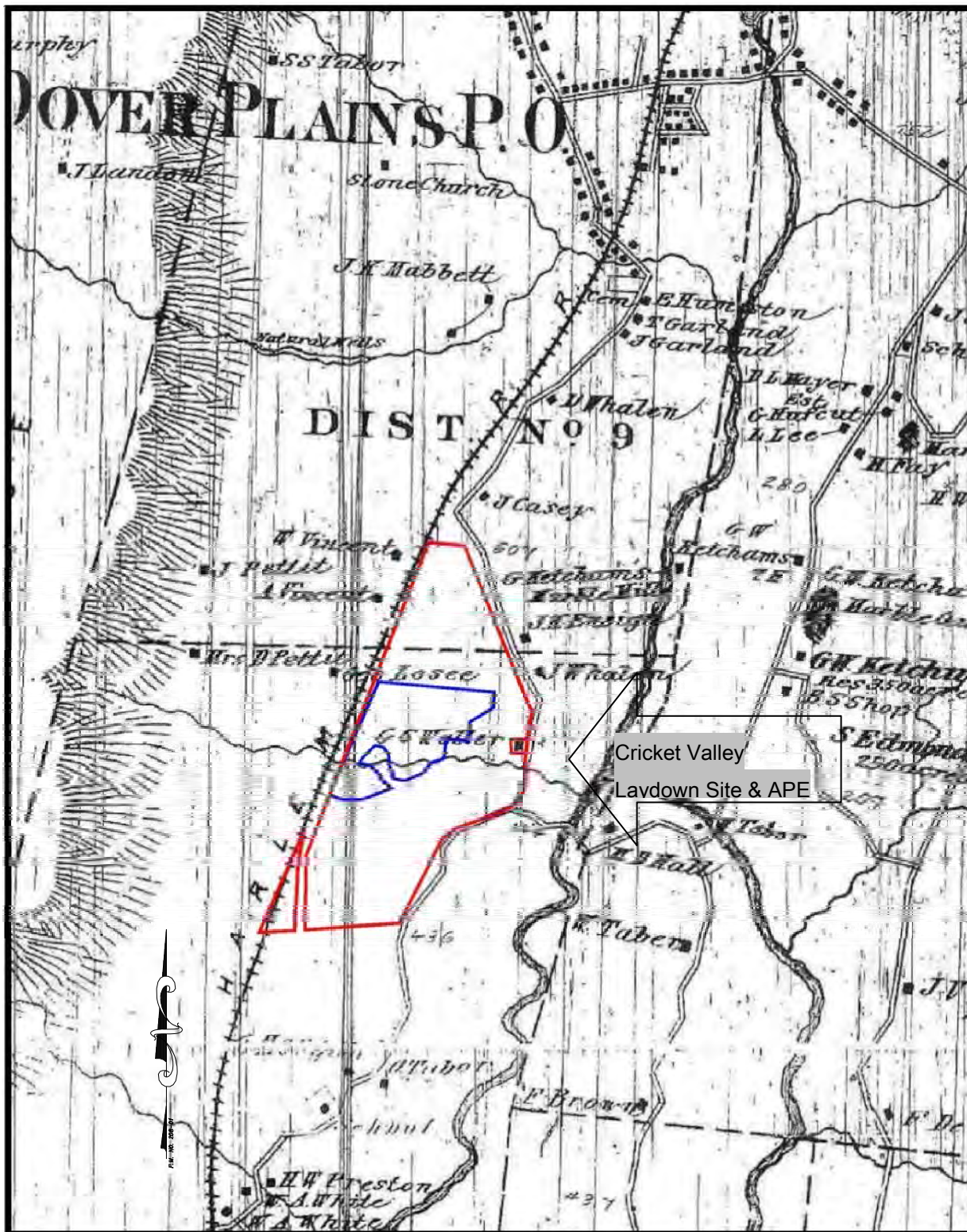

Map 6: O. W. Gray and Son's 1876 *New Illustrated Atlas of Dutchess County, New York*. Red line indicates property boundary. Blue line indicates APE. Scale: 1"=1500'.